



Aster Close

Abington Vale, Northampton

oriordanbond
SALES & LETTINGS



Aster Close

Abington Vale

NN3 3XG

GUIDE PRICE £240,000

A well presented two bedroom semi-detached home, located in this sought after cul-de-sac, within the heart of Abington Vale. The property is located within short walking distance of local shops, schools and Abington Park.

The accommodation comprises entrance hall, sitting/dining room and a fitted kitchen. To the first floor are two generous size bedrooms and a family bathroom. Outside to the rear is a southerly facing low maintenance garden with artificial lawn and good size decked patio. Outside to the front is a driveway for one vehicle plus an additional side driveway offering off road parking for two further vehicles. Further benefits include gas radiator heating and uPVC double glazing. (B/612/M)

Additional information

- Council Tax Band: B
- Energy Efficiency Rating: D

Viewing

Viewing strictly by appointment – details below

Disclaimer

O'Riordan Bond Estate Agents Limited has not tested apparatus, equipment, fittings or services and so cannot verify they are in working order. The buyer is advised to obtain verification from their solicitor or surveyor.

O'Riordan Bond Abington Vale Sales
01604 639007

abingtonvale@oriordanbond.co.uk



GROUND FLOOR

1ST FLOOR

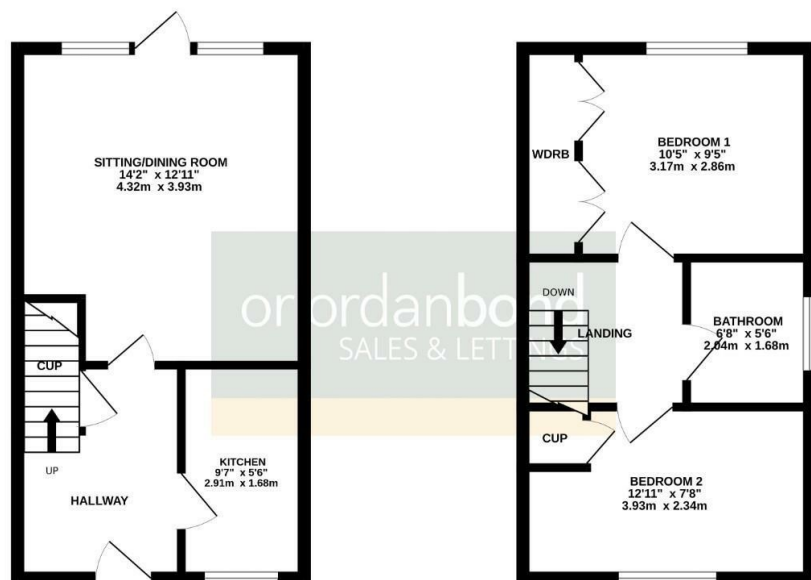

TOTAL FLOOR AREA: 612 sq.ft. (56.9 sq.m.) approx.

Whilst every attempt has been made to ensure the accuracy of the floorplan contained here, measurements of doors, windows, rooms and any other items are approximate and no responsibility is taken for any error, omission or mis-statement. This plan is for illustrative purposes only and should be used as such by any prospective purchaser. The services, systems and appliances shown have not been tested and no guarantee as to their operability or efficiency can be given.

Made with: Metreage, 2025